

## Waveguide Pressure Window

Dolph Microwave offers a standard product line of Waveguide Pressure Window, covering frequency from 0.3 to 110 GHz, the standard rectangular waveguide range from BJ3 to BJ900, the typical VSWR is 1.25 over the full waveguide bandwidth, and typical insertion loss is 0.2 dB. For more information please contact us and discuss your needs with our sales engineer.

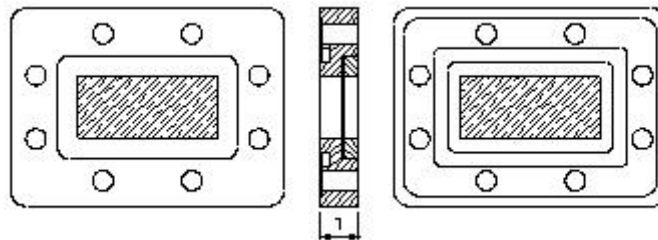

### ● Specifications

Model No*	Freq Range (GHz)	VSWR (Max)	WG Type		Flange	Material
			IEC	EIA		
DH-3WPW...	0.32-0.49	1.25	BJ3	WR2300	FDP/FDM	Al
DH-4WPW...	0.35-0.53	1.25	BJ4	WR2100	FDP/FDM	Al
DH-5WPW...	0.41-0.62	1.25	BJ5	WR1900	FDP/FDM	Al
DH-6WPW...	0.49-0.75	1.25	BJ6	WR1500	FDP/FDM	Al
DH-8WPW...	0.64-0.98	1.25	BJ8	WR1150	FDP/FDM	Al
DH-9WPW...	0.75-1.15	1.25	BJ9	WR975	FDP/FDM	Al
DH-12WPW...	0.96-1.46	1.25	BJ12	WR770	FDP/FDM	Al
DH-14WPW...	1.13-1.73	1.25	BJ14	WR650	FDP/FDM	Al
DH-18WPW...	1.45-2.20	1.25	BJ18	WR510	FDP/FDM	Al
DH-22WPW...	1.72-2.61	1.25	BJ22	WR430	FDP/FDM	Al/Cu
DH-26WPW...	2.17-3.30	1.25	BJ26	WR340	FDP/FDM	Al/Cu
DH-32WPW...	2.60-3.95	1.25	BJ32	WR284	FDP/FDM	Al/Cu
DH-40WPW...	3.22-4.90	1.25	BJ40	WR229	FDP/FDM	Al/Cu
DH-48WPW...	3.94-5.99	1.25	BJ48	WR187	FDP/FDM	Al/Cu
DH-58WPW...	4.64-7.05	1.25	BJ58	WR159	FDP/FDM	Al/Cu
DH-70WPW...	5.38-8.17	1.25	BJ70	WR137	FDP/FDM	Al/Cu

DH-84WPW...	6.57-9.99	1.25	BJ84	WR112	FBP/FBM/FBE	Al/Cu
DH-100WPW...	8.20-12.40	1.25	BJ100	WR90	FBP/FBM/FBE	Al/Cu
DH-120WPW...	9.84-15.0	1.25	BJ120	WR75	FBP/FBM/FBE	Al/Cu
DH-140WPW...	11.9-18.0	1.25	BJ140	WR62	FBP/FBM/FBE	Al/Cu
DH-180WPW...	14.5-22.0	1.25	BJ180	WR51	FBP/FBM/FBE	Al/Cu
DH-220WPW...	17.6-26.7	1.25	BJ220	WR42	FBP/FBM/FBE	Al/Cu
DH-260WPW...	21.7-33.0	1.25	BJ260	WR34	FBP/FBM/FBE	Al/Cu
DH-320WPW...	26.5-40.0	1.25	BJ320	WR28	FBP/FBM/FBE	Al/Cu
DH-400WPW...	32.9-50.1	1.3	BJ400	WR22	FUGP	Cu
DH-500WPW...	39.2-59.6	1.3	BJ500	WR19	FUGP	Cu
DH-620WPW...	49.8-75.8	1.3	BJ620	WR15	FUGP	Cu
DH-740WPW...	60.5-91.9	1.3	BJ740	WR12	FUGP	Cu
DH-900WPW...	73.8-112	1.3	BJ900	WR10	FUGP	Cu

\*Indicates Model Number. See Ordering Information for complete part number.

## ● Ordering Information

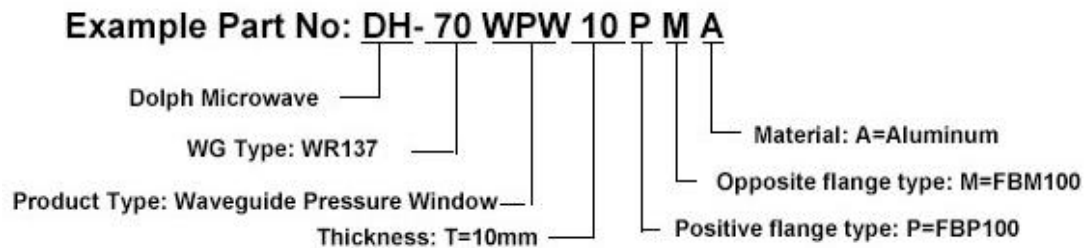

- Flange type: Multiple types available - see Dolph Microwave Flanges page.
- Finish: Corrosion protection plus black/grey top coat.